

APPENDIX D

A Proposal to the Rhode Island Board of Governors for Higher Education

Organizational Change: Transfer of the Department of Landscape Architecture from the College of the Environment and Life Sciences to the College of Arts and Sciences

A. General Information

A1. University of Rhode Island

A2. College of the Environment and Life Sciences (CELS)

A3. Department of Landscape Architecture

A4. July 1, 2015

A5. College of Arts and Sciences (A&S)

A6. Institutional review and approval process:

1. The Department faculty (LAR) unanimously voted to hold discussions with the College of Arts and Sciences about joining that college. (5-13-14)
2. Department chairs, faculty and administrators met over the summer to discuss LAR's possible move to A&S. (Summer-2014)
3. LAR met with the Dean and Associate Deans of A&S and was encouraged to continue a process where LAR prepared a short white paper explaining their proposal to join the college. (8-25-14)
4. LAR made a presentation proposing to join the college (A&S) at a college department chairs meeting (10-15-14).
5. The chair of LAR met with the Provost to explain the steps the department was taking to join the College of A&S (10-24-14)
6. At the fall semester meeting of The College of Arts and Sciences the college faculty voted unanimously to accept LAR into the college. (12-1-14)
7. The chair of LAR met with the Dean John Kirby of CELS to talk about next steps. Dean Kirby was supportive of LAR's move to A&S. (12-4-14)
8. At the fall semester meeting of The College of the Environment and Life Sciences an overwhelming majority voted to support the LAR Department in leaving the college. (12-9-2014)

9. Organizational Change Proposal to be submitted to the Curriculum Committee of the College of the Environment and Life Sciences. (Pending)
10. Curricular Affairs Comm. – FACSEN (Response pending)
11. FACSEN approval (Response pending)
12. University President approval (Response pending)
13. Revote of CELS (Response pending)

A7. The proposed change is to transfer the Department of Landscape Architecture from the College of the Environment and Life Sciences to the College of Arts and Sciences. This transfer will facilitate an integration of design, arts and planning in an exciting new configuration. It will offer diverse opportunities for students, faculty and the broader research community to engage and collaborate in classes and across disciplines within a common administrative unit. It will strengthen undergraduate and graduate programs in the arts, design and planning and stimulate collaborative research among allied fields at the University.

A8. Signature of the President _____

A9. At this time there are no new or additional resources needed to make this change.

A10. Will Green, Chair and Professor of Landscape Architecture, 874-2142, wagre@uri.edu

A11 Memorandum of Understanding stating that LAR faculty will continue to coordinate the EPD Program within MESM. (See Appendix A)

B. Rationale

B1. Landscape architecture is a collaborative discipline that interacts with diverse fields such as art, architecture, planning, engineering, and the natural and social sciences. These multiple disciplines commonly work together on diverse development and restoration projects. As the profession has matured and environmental problems become more complex, the need for interdisciplinary teamwork has grown. The Bachelor of Landscape Architecture (BLA) program at URI has a long tradition of engaging in collaboration through design. The Department of Landscape Architecture has doubled enrollments in the last few years, to nearly a thousand students per year. This past we year we taught a total of 911 students. The five dedicated LAR faculty taught an average of 164.4 students per faculty member for this time period, for an approximate average of 27.5 students per class (for all classes averaged). We believe we can increase these numbers over the next three to five years.

At a time of increasing competition for limited University resources and a desire to increase program and departmental enrollments, the Department of Landscape Architecture was asked by CELS to replace its well established accredited BLA with an MLA. With a great deal of discussion and anguish the faculty thought that such a move would be extremely risky in that too few students would attend a new and unaccredited master's program, when accreditation is a requirement for employment and professional licensure. Additionally, there are three leading MLA programs in our geographic region (Harvard, RISD and UMass).

For the past several years we have discussed a possible realignment with the College of Arts and Sciences based on many overlapping interests, professional relationships and opportunities for greater collaboration. While this was occurring, individuals from the department had joined with faculty from around the university to explore new opportunities in design. These discussions within Arts and Sciences led to a Department of Landscape Architecture vote to support a move from CELS to the College of Arts and Sciences.

Following discussions with the Arts and Sciences Dean's office, department chairs (A & S) met and voiced their support of LAR's proposal to move. On December 1, 2014, the faculty of Arts and Sciences voted unanimously in favor of the move. The Deans of both colleges have also endorsed this move. Dean Winifred Brownell stated that *landscape architecture brings an accredited design program to the college, one that is recognized for its strong record of service, service-learning and its tradition of collaborating with the arts and sciences while leading to jobs*. We believe that a move will bring us closer to the arts, create new opportunities for working with faculty from within the College of Arts and Sciences, and will allow for maintaining relationships with colleagues from the colleges of the Environment and Life Sciences, Engineering and Business'. It should also be noted that we will continue to maintain our commitment to the sciences in order to provide for a strong and well-balanced curriculum in Landscape Architecture.

Given an opportunity to discuss our current situation with the CELS faculty (at the CELS fall semester meeting) they recognized and endorsed our request for transfer. Our faculty is excited to pursue a new direction. Based upon common interests and with new opportunities, relationships and emerging synergies, it is easy to envision the department's relocating from CELS to the College of Arts and Sciences. The Art Department already serves as a strong foundation for LAR students. We require ART 207 and encourage our students to take other art classes which serve as supporting electives. Students commonly enroll in 2 and 3 dimensional design classes, photography, digital art and art history and they attend art exhibits and shows. This past year students learned the value of interdisciplinary collaboration from URI's first visiting artist, Francis Whitehead, who also lectured and critiqued LAR student designs. The LAR faculty also participated in a new collaborative design initiative. During this past year, discussions between faculties indicated a desire to build closer relationships between the disciplines

of landscape architecture, art, fine arts, engineering and textiles and merchandising. The synthesis here could be to establish a school or center of design.

C. Institutional Role – How the change relates to the mission and is compatible with the organizational structure of the institution.

C1. Organizational change consistent with the role and mission of the institution and compatible with institutional planning: The department of landscape architecture has evolved as an accredited degree program built on a successful Bachelor of Landscape Architecture degree (BLA). This program prepares students for careers that address a range of complex issues facing coastal communities and urban centers in a time of major shifts in environmental conditions (e.g., climate change, sea level rise, and urban development). Our graduates find jobs throughout the New England region and around the nation in private and public practices that focus on a wide range of project types. They include parks, residences, and campuses; urban plazas, streets and commercial developments as well as brownfields, coastal edges and sustainable communities. For success within the professional realm, the new generation of landscape architects, planners and decision-makers (our students) require skills and experiences that will prepare them to address the complexities of designing for multiple stakeholders in urban areas and in the dynamic coastal zone. A move to the College of Arts and Sciences will contribute to our mission and is consistent with critical themes articulated in the Academic Plan in the following ways:

1. Enhancing Academic Quality and Value through interdisciplinary and experiential learning and discovery – This proposed move will build on our successful Bachelor of Landscape Architecture degree (BLA) program as we prepare a new generation of designers. The Department of Landscape Architecture will continue to deliver a curriculum rich in field investigation and analysis, collaboration and hands-on learning. Through service-learning projects for public sector clients our students are already exposed to interdisciplinary learning. With a move into the College of Arts and Sciences, our students will have further opportunities to experience the arts and to collaborate with students and faculty with diverse backgrounds and skills. A move to a new college will create new opportunities for student interactions across disciplines and colleges. The emphasis on design and new partnerships in the college will lead to more opportunities and greater communication across disciplines both within and outside of the University.

2. Prepare Students for a Changing World - A changing world requires an innovative and bold vision. Climate change will impact life within the coastal region and beyond and pose major design challenges for the world as we move deeper into the 21st century. Many of the implications will affect our cities and the urban environments as well. By educating students in design and innovation they will be better prepared

for careers in a rapidly changing world. Faculty and students in design, planning and the arts, engineering and sciences will have new opportunities for working together, developing new skills and communicating ideas in ways that make use of new and traditional materials, cutting edge technologies, and innovative methods of expression. Through our curriculum students will learn to design and illustrate alternative scenarios for coping with, planning for, and addressing conditions affecting the landscape, its communities and infrastructural systems. Through service-learning studios, students provide assistance to towns and villages. They identify and assess problems that are reflective of a changing world and develop sound design solutions to these problems, which they present in public settings around the state. Problematic issues they may address include: What will a storm surge barrier look like and how will green infrastructure improve a community? Who will be impacted by storms and what might it mean for a coastal community that may not exist at all in 75 years? What will change look like and how will it be implemented? This form of service-learning studio prepares students for careers in the profession as it deals with collaborative and real-world problem solving with emphasis on our changing world.

3. Research, Scholarship and Innovation (Creative Work) - Landscape Architecture will address climate change, infrastructure, transportation, renewable energy and urban development through innovative design, research, visualization, and outreach in ways that will put URI on the map as a global leader in designing solutions to these very local and very global challenges. The BLA will continue to attract high performing high-school graduates, as well as undergraduate students from other majors within the institution, and transfer students from accredited design programs in other states. Together these students will work in service-learning studios and as research assistants for faculty engaged in creative and research endeavors. Their efforts will contribute to greater impacts and prominence for the department, the college and the university.

Graduate students enrolled in the Environmental Planning and Design track (EPD) -- of Master of Environmental Science and Management (MESM), administered through landscape architecture, will have opportunities to work with faculty in research roles focused on addressing critical and complex environmental and design issues. Working in collaboration with designers, artists, and social scientists these students will develop innovative solutions to problems such as failing infrastructure associated with communities within the region. Their focus will be on creating functional environments for living, work, and play that are resilient, sustainable and provide environmental protection. They will play a necessary role to help communities understand options and make hard decisions.

4. Global Partnerships and International Programs - In the emerging field of coastal adaptation; we consider it both an opportunity and a responsibility to train the next

generation of problem solvers. The anticipated impacts of climate change will be particularly severe in many of the world's developing nations. We welcome collaboration within the university through university-wide partnerships. We encourage students to study abroad recognizing the need for graduates to be able to speak and work with people from different countries and cultures. In recent years we have established relationships with universities in New Zealand, Australia, Ireland and South Africa, invited speakers from Mexico, South Africa and Australia to participate in the LAR Lecture series and have pursued new relationships with Institutions of Higher Education in Indonesia.

5. Ensure an Equitable and Inclusive Campus Community - At the present time the Department of Landscape Architecture at URI lacks diversity in its full-time faculty. We have been successful in attracting diverse faculty on a per course basis however we look to relying on full-time faculty to support diverse initiatives in the future. (It should be noted that during the last four years, the department developed competitive proposals for underrepresented faculty and also for faculty with specialties in green infrastructure and sustainable practices and technologies. These proposals were selected by the dean of CELS for consideration by the Provost. These positions, which could have given us greater capacity, were not supported. We remain committed to building a more diverse and equitable faculty and student body.

6. Institutional Effectiveness - Landscape Architecture has maintained a fully accredited degree for 25 years. During that time the Landscape Architecture Accreditation Board and its visiting teams have indicated that this program is lean and effective in delivering its curriculum. We are excited by the opportunity afforded by this move to leverage this reputation and to meet the emerging challenges of the 21st century. As a department we are also supportive of the idea of developing and implementing either an undergraduate or graduate planning degree, that could utilize existing resources and curricular material found within the department and institution. We are set to begin offering a certificate of planning in 2015-2016.

D. Interinstitutional Considerations

D1. The BLA degree program in landscape architecture is the only degree of its kind offered at any public institution within the State. There are four accredited BLA programs in New England, including: the Boston Architectural College (private institution), University of Massachusetts, University of Connecticut and University of Rhode Island. Because of their distant locations from each other, there is little interaction that occurs within a studio setting.

URI is one of 15 institutions nationwide offering a stand-alone BLA degree. In addition, landscape architects are required by law to be licensed to practice. (To become licensed, one needs a degree from an accredited program in landscape architecture as well as successful completion of the licensing exam.)

DEGREE PROGRAMS	AMT	% total
<i>Accredited Degree Programs offering combined MLA & BLA</i>	56	58%
<i>Accredited Degree Programs offering a stand-alone BLA</i>	15	16%
<i>Accredited Degree Programs offering a stand-alone MLA</i>	25	26%
Total LAAB Accredited Degree Programs in the US	96	

While the trend appears to be in establishing more graduate programs, recent statistics indicate that some of the newer graduate programs are having difficulty in attracting new students due to competition with existing programs as well as challenges associated with location (Rowley, KSU/CELA 2014). Based upon this analysis, current trends will give stand-alone BLA programs an edge in attracting highly qualified undergraduate students. There is a continuing regional need in the profession for qualified undergraduate students with BLA degrees. We intend to be the best stand-alone BLA programs in the region.

D2. The Department of Landscape Architecture BLA degree is associated with the New England Regional Student Program offering tuition incentives to students from Maine, Vermont and New Hampshire. This status will not change.

D3. There are no external affiliations associated with the Department of Landscape Architecture.

E. Facilities and Capital Equipment:

E1. Currently there is no immediate need to expend resources related to the organizational change. Our faculty resources, operational budget and lab fees, while limited, are sufficient to maintain our department programs as they currently exist.

Space and Equipment

The following is a summary of Space and Equipment associated with the Department of Landscape Architecture. Status of space and equipment is that both meet our current

teaching, research and outreach needs. In addition, these resources are essential to our continued success and accreditation status.

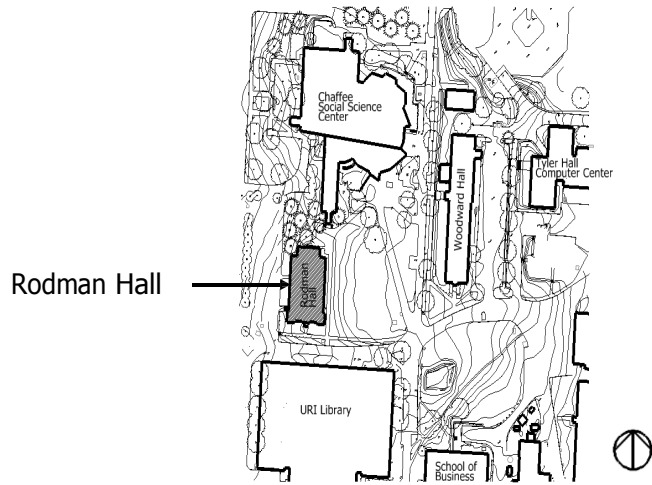

Area Map:

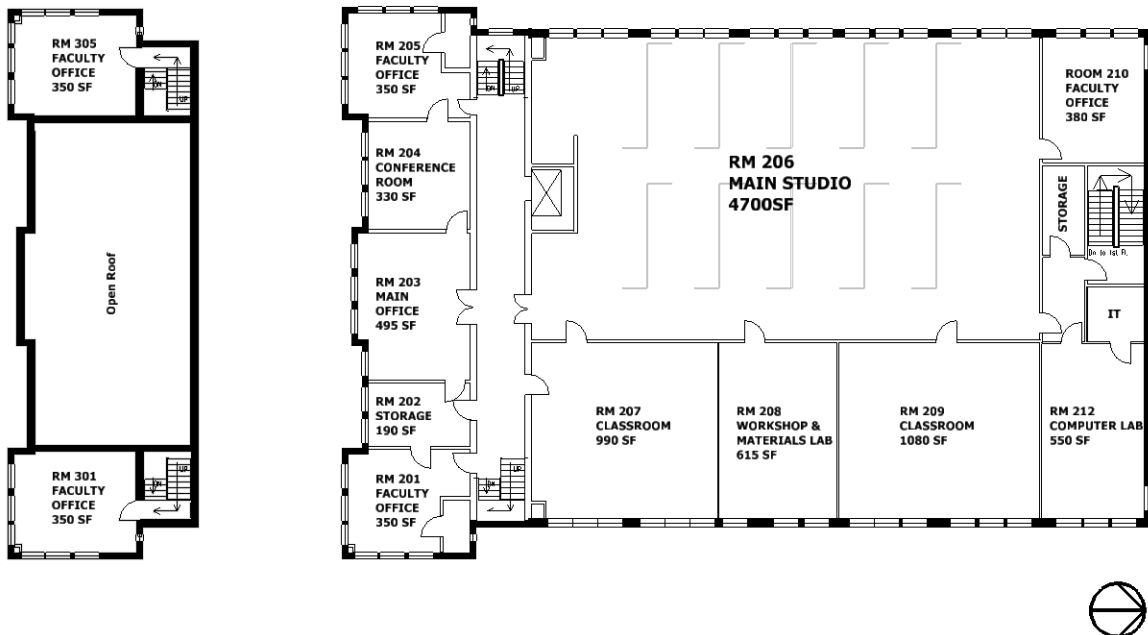

Floor Plans – 2nd and 3^d floors in Rodman Hall:

LAR Space	Room Number and Building	Area in Square Feet	Capacity		Exclusive or Shared Use
			Norm.	Max.	
Faculty Office (<i>Green</i>)	Rodman Hall 201	350	1	1	Exclusive
Storage Main	Rodman Hall 202	190	1	1	Exclusive
Office Conference Room	Rodman Hall 203	495	2	2	Exclusive
Faculty Office (<i>Sheridan</i>)	Rodman Hall 204	330	9	15	Exclusive
Studio	Rodman Hall 205	350	1	1	Exclusive
Classroom	Rodman Hall 206	4700	56	60	Exclusive
Workshop	Rodman Hall 207	990	20	35	Exclusive
Classroom	Rodman Hall 208	615	6	10	Exclusive
Faculty Office (<i>Simeoni</i>)	Rodman Hall 209	1080	20	25	Exclusive
Computer Lab	Rodman Hall 210	380	1	1	Exclusive
IT Closet	Rodman Hall 212	550	7	12	Exclusive
Storage Closet	Rodman Hall 212A	100	-	-	Telecom
Faculty Office (<i>Gordon</i>)	Rodman Hall 214	110	-	-	Exclusive
Faculty Office (<i>Atash</i>)	Rodman Hall 301	350	1	1	Exclusive
	Rodman Hall 305	350	1	1	Exclusive

Technical Equipment in Offices, Classrooms and Studio Spaces

1. Each faculty office contains a computer and high-speed internet connection and wireless.
2. The student computer lab (RM 212) contains five computers, which have a full array of software including AutoCAD, MicroStation, Photoshop, InDesign, SketchUp and Microsoft Office Professional. This lab is also equipped with a flatbed scanner. It is networked to a color printer located in the Main Office (RM203).
3. The Main Office (RM 203) contains two office copiers (RICOH MP500A, RICOH MP2510), a student copier (MP161) as well as an HP8600 Officejet Pro, Printer, Scanner and Fax. In addition, an HP Designjet 2300 large format plotter/scanner and a Makerbot Replicator 2X3-d plotter are also located in the Main Office.
4. Each Classroom (RM 207 & 209) is equipped with digital projectors and screens. Room 207 is also equipped with an Epson ELPDC11 document camera.
5. There are 25 Dell wide-screen monitors located in studio at student workspaces.
6. The Workshop (RM208) contains an array of very basic tools for model construction as well as a library of various construction materials.

E2. Currently there are no renovations underway or planned. Rodman Hall is however, an aging building that receives periodic maintenance to its windows, clearstory skylight and mortared stone façade.

E3. NA

F. Financial Considerations

F. Financial Considerations

F1. Anticipated expenditures related to the change: None

Budget – The overall 2014 FY budget is provided as is a comparison chart showing department budgets over a three-year period (please see Appendix 1). Please note that prior to this reporting, the budget item for administrative support, which include one full-time clerk typist, was transferred from the department budget to the dean's office. In the fall of 2013, this full-time position was eliminated and replaced with graduate and undergraduate student support. In addition, the costs for new technology, which may be a line item in an annual budget, do not accurately reflect the costs for technology purchases, which are made by the department with assistance from the dean's office. Purchases in 2014 included a digital projector, document camera, 3-d printer, projector screen, chairs, and classroom tables.

Personnel - It is anticipated that all salaries, benefits, summer recontracting, faculty development, administrative assistance and per course instruction funds, will continue to be allocated following the same or a similar formula.

Accreditation and membership in LAAB – Landscape Architecture is an accredited program requiring membership in LAAB. It also requires that programs prepare an annual report and a self-study report which is part of an accreditation process which includes a review team visit, which occurs every six years. Costs associated with the accredited program are paid for through the Provost's office.

Operating Budget – Operating Budgets and lab fees are critically important for the Department of Landscape Architecture. Lab fees are expected to remain the same or to reflect a rise associated with digital printing costs. Technology continues to change and is required of a professional program that is preparing young professionals for careers in their chosen field. Satisfying technology needs through hardware and software purchases will continue to be a necessity of the program.

Certificate in Community Planning – The department has recently completed and received approval for a Certificate in Planning that is expected to begin accepting students in the fall 2015.

FY14 LAR Department Budget (1-21-2015)

Department Name	Chartfield	Chartfield Description	Org Level	Mgmt Summ	Budget	Comments		
Landscape Architecture	100-2006-0000	General Revenue	STATE	Faculty Salaries Adminsitrative Support Staff Salary	527,995 7,466	FY15 Salaries, including dept chair supplement \$4,500		
			STATE Total			535,461	FY15 Salary	
			FRING2	Fringe			TBD by Budget	
			FRING2 Total			0		
			INHSPAYRLL	All Other Int Payroll	0			
				Per Course Lecturers	18,851		FY14 Budget Allocation was \$8,944; additional \$5,162 for office support	
				Student Help	14,106		One month dept chair	
				Summer Recontract/Research	12,278			
			INHSPAYRLL Total			45,235		
			OPER1	Postage	0		FY14 Operating Level	
				Printing	0			
				Telephone	2,152		FY14 Budget	
			OPER1 Total			2,152		
			OPER2	All Other Operating	6,881		FY14 Budget	
				Contractual Svcs	550		FY14 Budget	
				Travel	1,500		FY14 Budget	
			OPER2 Total			8,931		
			100-2006-0000 Total				591,779	
			100-2006-2000	Course Fees	STATE	Overtime	0	
	STATE Total				0			
	OPER2	All Other Operating			10,530	FY14 Budget		
	Travel	600				FY14 Budget		
	OPER2 Total			11,130				
	100-2006-2000 Total				11,130			
	100-2006-1000	Faculty Dvlpmt	OPER1	Printing	120	FY14 Budget		
			OPER1 Total			120		
			OPER2	All Other Operating	894	FY14 Budget		
OPER2 Total			894					
100-2006-1000 Total				1,014				
LAR (Community Plan and Land-Arch) Total					603,923			

G. Evaluation

G1. Criteria that may be used to evaluate the success of the move may include the following and will become part of the annual accreditation reporting and the accreditation self-evaluation report, which is prepared every six years:

1. Number of students entering the program as freshmen

2. Number of students filling the sophomore gateway studio class: LAR243. This class and other studios are capped at a maximum of 20 LAR majors.
3. The number of students graduating with BLA degrees.
4. The number of graduates finding employment in the industry.
5. Other criteria include research topics, students and funding, service-learning studio projects, and awards that classes or individual students garner.

Will Green

Digitally signed by Will Green
DN: cn=Will Green, o=URI, ou=LAR,
email=wagre@uri.edu, c=US
Date: 2015.02.12 16:18:32 -05'00'

Department: William A. Green, Chair

Catherine English

Digitally signed by Catherine English
DN: cn=Catherine English, o=University of Rhode Island, ou=Nutrition
and Food Sciences, email=cathy@uri.edu, c=US
Date: 2015.02.13 09:20:47 -05'00'

College of the Environment and Life Sciences



Digitally signed by Anne Veeger
DN: cn=Anne Veeger, o=Associate Dean,
ou=CELS, email=veeger@uri.edu, c=US
Date: 2015.02.13 11:50:16 -05'00'

Dean, College of the Environment and Life Sciences

CAC

Faculty Senate

President, University of Rhode Island

Rhode Island Board of Higher Education

February 12, 2015

date:

February 13, 2015

date:

February 13, 2015

date:

date:

date:

date:

date:



February 23, 2015

Faculty Senate
Green Hall
URI

Dear Colleagues:

This is to confirm that the Department of Landscape Architecture has proposed to move from the College of Environment and Life Sciences to the College of Arts and Sciences. On December 1, 2014, during a regularly scheduled meeting of the faculty of the College of Arts and Sciences, Professor William Green delivered a presentation on the Landscape Architecture department faculty and programs that he had presented previously to all department heads in Arts and Sciences. After discussion, the faculty then voted unanimously to approve the move of the Department of Landscape Architecture to the College of Arts and Sciences.

We expect that the programs that are currently offered by the Department of Landscape Architecture (the BLA major; the CPL, GEG, and LAR minors; and the Planning Certificate) will continue to be offered by the Department of Landscape Architecture and will move, along with the Department and all resources (including faculty, staff, space, materials, budget, endowments, and overhead) to Arts and Sciences. Following approval by the Faculty Senate, President, and Board of Education, we can implement the move as soon as July 1, 2015. The faculty in Arts and Sciences were particularly interested in the possibility of forming a school of arts and design in Arts and Sciences that would include Landscape Architecture.

Cordially,

Winifred Brownell, Dean
College of Arts and Sciences

Landscape Architecture
Departmental Budget
APPENDIX A . Organizational Change: Transfer of the Department of Landscape Architecture from the College of the Environment and Life Sciences
to the College of Arts and Sciences

FY14 LAR Department Budget 1-21-2015

Department Name	Chartfield	Chartfield Description	Org Level	Mgmt Summary	Budget		
Landscape Architecture	100-2006-0000	General Revenue	STATE	Faculty Salaries Administrative Support Staff Salary	527,995 7,466		
			STATE Total		535,461		
			FRING2	Fringe			
			FRING2 Total		0		
			INHSPAYRLL	All Other Int Payroll		0	
					Per Course Lecturers	18,851	
					Student Help	14,106	
					Summer Recontract/Research	12,278	
				INHSPAYRLL Total		45,235	
				OPER1	Postage Printing Telephone	0 0 2,152	
			OPER1 Total			2,152	
			OPER2	All Other Operating	6,881		
				Contractual Svcs	550		
				Travel	1,500		
			OPER2 Total		8,931		
			100-2006-0000 Total				591,779
			100-2006-2000	Course Fees	STATE	Overtime	0
					STATE Total		0
		OPER1			All Other Operating Printing		
						OPER2 Total	
	OPER2	All Other Operating Capital Travel			10,530 600		
					OPER2 Total		11,130
	100-2006-2000 Total				11,130		
	100-2006-1000	Faculty Dvlpmt		OPER1	Printing	120	
				OPER1 Total		120	
				OPER22	All Other Operating Travel	894	
			OPER2 Total			894	
	100-2006-1000 Total				1,014		
LAR (Community Plan and Land-Arch) Total					603,923		

FY2013 Expenses

FY2013 Expenses	FY2013 Adjustments	FY2013 Revised Expenses	Comments
497,821		497,821	FY15 Salaries, including dept chair supplement \$4,500
		0	FY15 Salary
497,821		497,821	
177,251		177,251	TBD by Budget
177,251		177,251	FY13 Actuals
0		0	
19,783		19,783	FY14 Budget Allocation was \$8,944; additional \$5,162 for office support
11,725		11,725	
11,920		11,920	One month dept chair
43,428		43,428	
0		0	FY14 Operating Level
29		29	
1,569		1,569	FY14 Budget
1,598		1,598	
8,890		8,890	FY14 Budget
540		540	FY14 Budget
2,546		2,546	FY14 Budget
11,976		11,976	
732,074		732,074	
0		0	
0		0	
24		24	
0		0	
24		24	
11,208		11,208	FY14 Budget
0		0	
357		357	FY14 Budget
11,565		11,565	
11,589		11,589	
0		0	
0		0	
772		772	
243		243	
1,015		1,015	
1,015		1,015	
744,678		744,678	

FY2012 Expenses

FY2012 Expenses	FY2012 Adjustments	FY2012 Revised Expenses	Comments
492,711		492,711	FY15 Salaries, including dept chair supplement \$4,500
0		0	
492,711		492,711	
167,246		167,246	FY12 Actuals
167,246		167,246	
7,434		7,434	Temporary office support (J. Smith)
29,383	(5,500)	23,883	LAR344 per course for Sheridan release for Field Laboratories plan
9,298		9,298	
12,616	(1,500)	11,116	A. Simeoni summer salary
58,731		51,731	
79		79	
137		137	
1,401		1,401	
1,617		1,617	
8,798		8,798	
6,103	(4,200)	1,903	Provost contribution to visiting scholar
			Provost contribution to visiting scholar (\$3,300);
			Provost student travel support (\$200)
6,288	(3,500)	2,788	
21,189		13,489	
741,494		726,794	
0		0	
0		0	
8		8	
0		0	
8		8	
7,990		7,990	
3,811		3,811	
269		269	
12,070		12,070	
12,078		12,078	
		0	
0		0	
997		997	
997		997	
997		997	
754,569		739,869	

FY14 LAR Department Budget 1-21-2015

Landscape Architecture
Departmental Budget

Department Name	Chartfield	Chartfield Description	Org Level	Mgmt Summary	FY2014 Budget	FY2013 Expenses	FY2012 Expenses	
Landscape Architecture	100-2006-0000	General Revenue	STATE	Faculty Salaries	527,995	497,821	492,711	
				Administrative Support Staff Salary	7,466	0	7,434	
			STATE Total		535,461	497,821	492,711	
			FRING2	Fringe				
			FRING2 Total		0	0	0	
			INHSPAYRLL	All Other Int Payroll	0	0	0	
				Per Course Lecturers	18,851	19,783	23,883	
				Student Help	14,106	11,725	9,298	
				Summer Recontract/Research	12,278	11,920	11,116	
			INHSPAYRLL Total		45,235	43,428	44,297	
			OPER1	Postage	0	0	79	
				Printing	0	29	137	
				Telephone	2,152	1,569	1,401	
			OPER1 Total		2,152	1,598	1,617	
			OPER2	All Other Operating	6,881	8,890	8,798	
				Contractual Svcs	550	540	1,903	
				Travel	1,500	2,546	2,788	
			OPER2 Total		8,931	11,976	13,489	
	100-2006-0000 Total				591,779	554,823	552,114	
	100-2006-2000	Course Fees	STATE	Overtime	0	0	0	
			STATE Total		0	0	0	
			OPER1	All Other Operating		24	8	
				Printing		0	0	
			OPER2 Total		0	24	8	
			OPER2	All Other Operating	10,530	11,208	7,990	
				Capital		0	3,811	
				Travel	600	357	269	
			OPER2 Total		11,130	11,565	12,070	
			100-2006-2000 Total				11,130	11,589
	100-2006-1000	Faculty Dvlpmt	OPER1	Printing	120	0	0	
			OPER1 Total		120	0	0	
			OPER22	All Other Operating	894	772	997	
				Travel		243		
	OPER2 Total		894	772	997			
	100-2006-1000 Total				1,014	772	997	
	LAR (Community Plan and Land-Arch) Total					603,923	567,184	565,189



Advocating, advancing, and evaluating quality education in Landscape Architecture

Kristopher Pritchard
Accreditation and Education
Programs Manager

March 4, 2015

Board Members

Practitioners
Rodney Swink, FASLA

Joy Lyndes, ASLA
Coastal Sage

Karl Von Bieberstein, FASLA
Newman Jackson Bieberstein

Educators
Stephanie Rolley, FASLA, Chair
Kansas State University

Ned Crankshaw, ASLA
University of Kentucky

Gary Kesler, FASLA
Pennsylvania State University

Public Representatives
Linda Battram

Lucinda McDade, Ph.D.

Tom Jacobs

ASLA Representative
Leonard Hopper, FASLA

CELA Representative
Kenneth Brooks, FASLA
Arizona State University

CLARB Representative
Tom Sherry, ASLA

William A. Green, ASLA, Chair
Department of Landscape Architecture
University of Rhode Island
Rodman Hall
94 West Alumni Avenue
Kingston, Rhode Island 02881

Dear Professor Green,

Thank you for providing the Landscape Architectural Accreditation Board (LAAB) information outlining the expected transfer of the University of Rhode Island's Department of Landscape Architecture from the College of the Environment and Life Sciences to the College of Arts and Sciences. I was able to review the document and understand the reasoning and rationale for the move.

After reviewing the document you provided and comparing the details against the LAAB Accreditation Standards and Procedures (the Standards), it appears that this move into a different college within the university will not affect the program or its current accreditation status. There is no requirement throughout the Standards which states a program must be housed in a particular college. Many Landscape Architecture programs are often housed in various colleges in universities throughout the country, given the variety of topics covered throughout a program.

Therefore, it appears that making a move to the College of Arts and Sciences does not put the Landscape Architecture program in jeopardy of being out of compliance with the Standards and will allow the program to maintain its current accreditation status. The LAAB Board of Directors, through an LAAB ROVE team currently scheduled to visit the program in Fall 2015, will have an opportunity to determine if the program has maintained compliance with accreditation standards and have its accreditation renewed.

Please let me know if I can be of any further assistance in this matter. I can be reached at kpritchard@asla.org or 202.216.2359.

Sincerely,

A handwritten signature in black ink, appearing to read "KPRITCHARD", with a stylized flourish at the end.

Kristopher D. Pritchard
Accreditation and Education Programs Manager
LAAB